

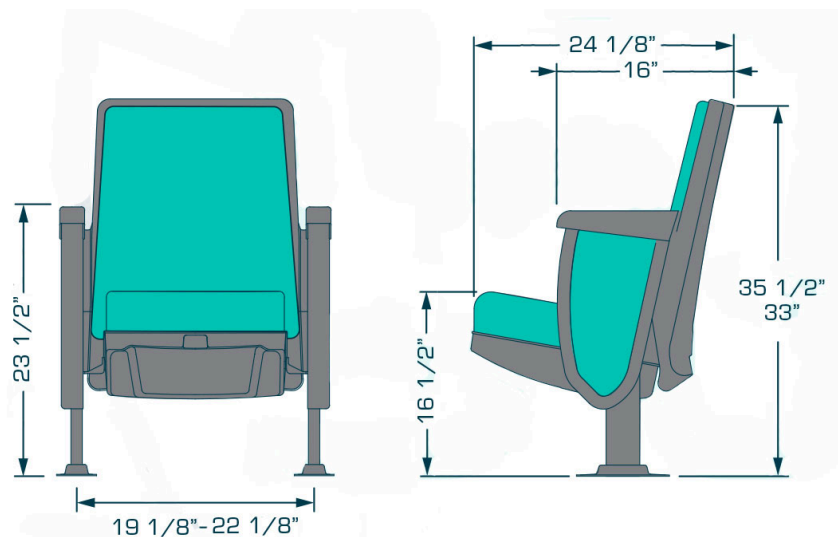

# Compact Convention Chair

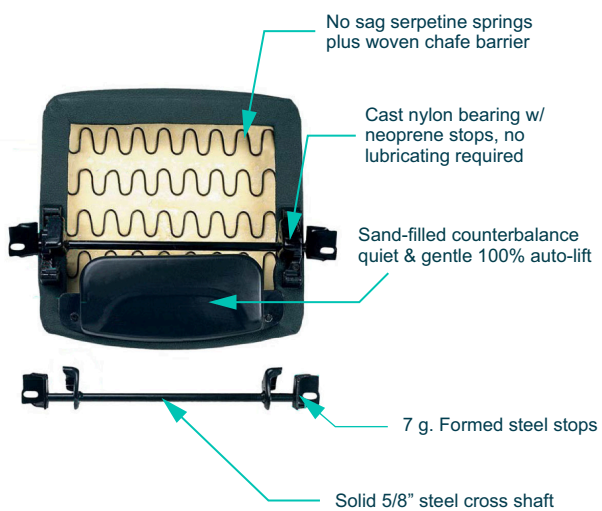

# ARM OPTIONS

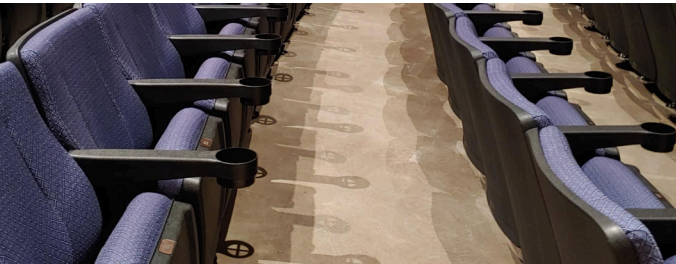

Polypropylene armrest with front molded cup holder. Adds an approximate 4" to depth of chair.

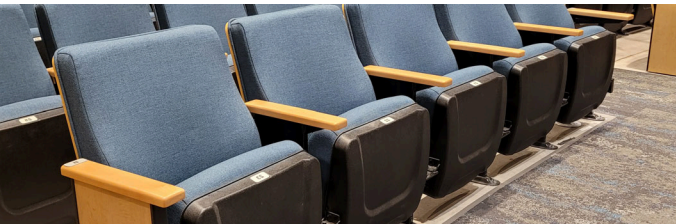
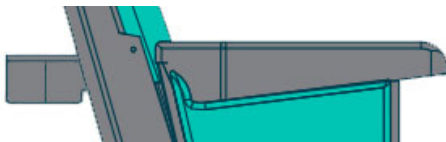

Flat

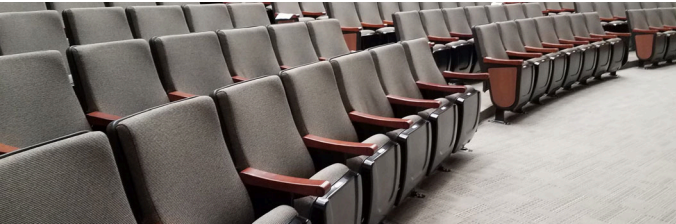

Scrolled

Solid wood armrests. Choice of wood and stain. Length within typical depth of chair.



Longitudinal

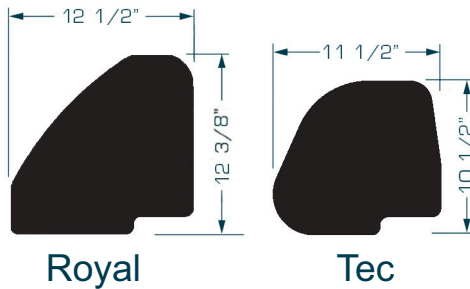

Royal

Tec

Pricing can vary based on materials used. Please call 800-584-9733 to speak with a sales associate to discuss details or to obtain more accurate pricing.

# BACK OPTIONS

Each of our backs use 50/55 kg/m<sup>3</sup> foam affixed to an injection molded, high-density polypropylene inner back with ¼" reinforced ribbing. Polypropylene is textured to resist scratching and scuffing. Additional outer back options include laminate or wood veneer.

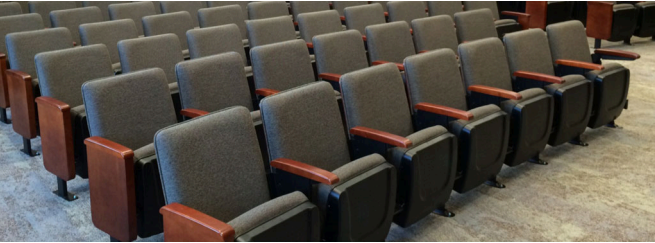

## Flat

2" thick foam



## Lumbar

2" thick foam increasing to 3" at lumbar area

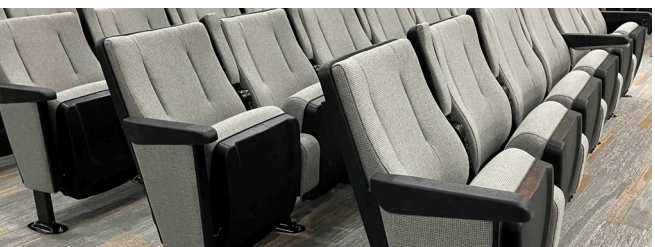

## Vertical Pleats

2" thick foam increasing to 3" at lumbar area with decorative vertical pleating

Button pleating also available



## Opera

2" thick foam with soft curve at top of back.

Pricing can vary based on materials used. Please call 800-584-9733 to speak with a sales associate to discuss details or to obtain more accurate pricing.

# ROW ENDS

Create a unique space by adding custom row ends to your installation. PLAM to cast aluminum to polypropylene, row ends can significantly change the entire feel of the room. Below are common ends provided by DFC. Looking for something you don't see, let us know and.....!

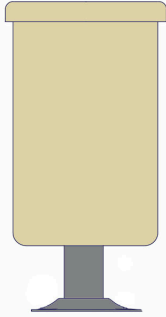

3/4 Soft Rectangle

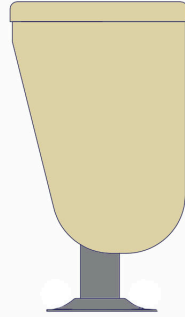

3/4 Tapered Radius

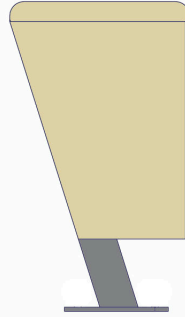

3/4 Tapered

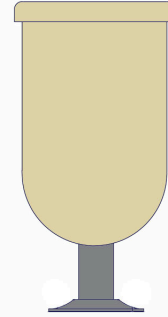

3/4 Radius

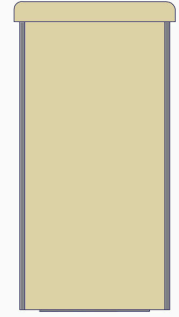

Full-Length Panel

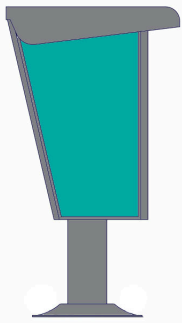

Convention T

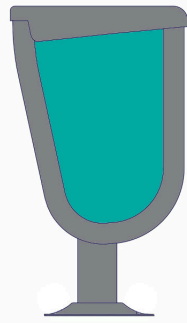

Oval 300

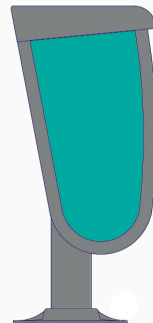

Compact

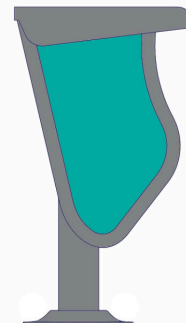

Roma S

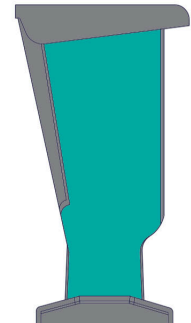

HPL (Poly)

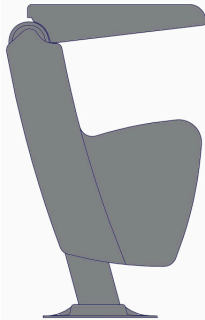

Lifting Arm/Cantilever

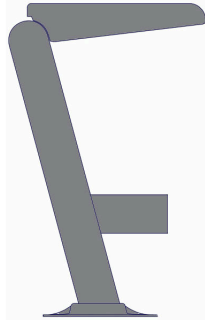

Open End

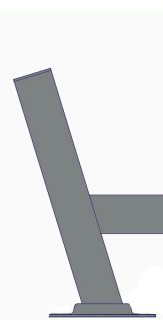

Open Armless

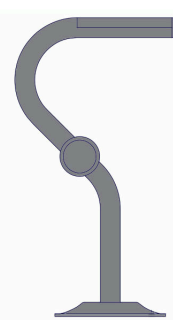

Cane

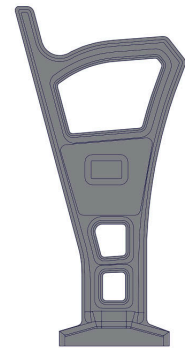

HPL Roma (Poly)



Kokomo



Elizabeth City

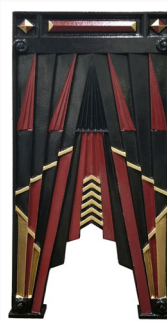

The Roxy



Wild Rose

Pricing can vary based on materials used. Please call 800-584-9733 to speak with a sales associate to discuss details or to obtain more accurate pricing.

# LIGHTING

DFC is pleased to provide several options for aisle lighting. Talk to us about your lighting needs or requirements and we will match a great option for your project. Listed Class II 12V DC power supply provided with all orders.

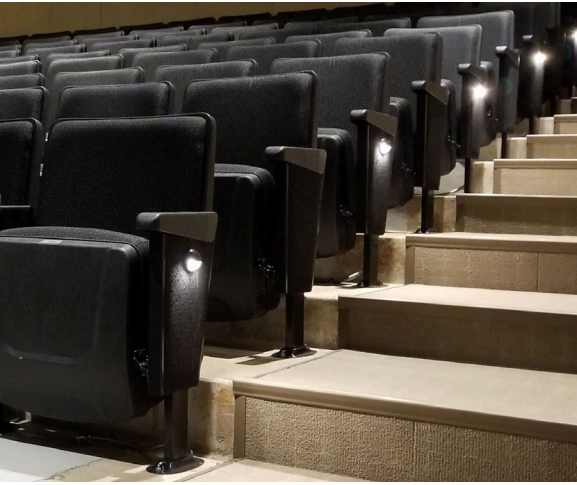

## Tivoli Beacon

Yellow, White, and Warm White

Replaceable AC/DC LED board inside polycarbonate dome

50,000 hrs (White and Warm White) / 100,000 hrs (Yellow)

Ideal for row ends with plastic armrests

Specifications available upon request

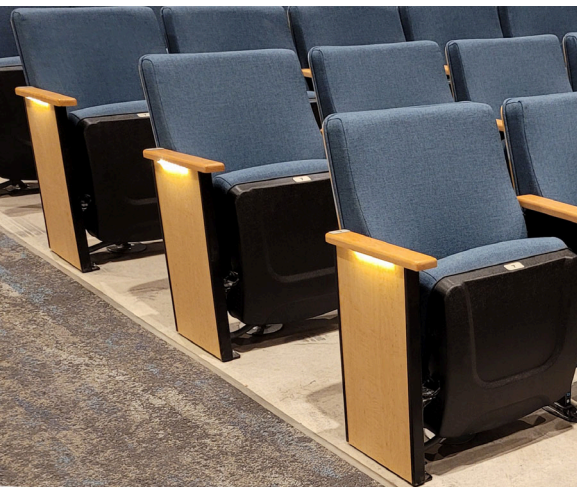

## Tivoli Versiline

Yellow, White, and Warm White

LEDs set in polycarbonate clear tube

40,000 hrs (White and Warm White) / 100,000 hrs (Yellow)

Typically used with row ends with wood armrests

Specifications available upon request



## Tivoli Mode

Yellow and Warm White

LEDs set in polycarbonate shroud

75,000 hrs life expectancy

Great for all applications

Specifications available upon request

Pricing can vary based on materials used. Please call 800-584-9733 to speak with a sales associate to discuss details or to obtain more accurate pricing.

# OPTIONS

DFC aims to provide a complete comfortable experience. Often time this can include conveniences not found in a typical seat setting. Available options below can take your space from typical to tremendous.



**Anti-Tip Movable Bases**



**Card, Pencil & Communion cup**



**Era Restoration**



**Custom Engraving Capabilities**

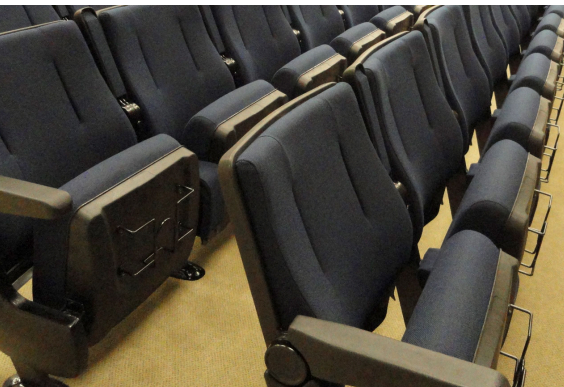

**Under-seat book racks**



**Custom Embroidery Available**

Pricing can vary based on materials used. Please call 800-584-9733 to speak with a sales associate to discuss details or to obtain more accurate pricing.